



## *The Sendriya Shouchalaya*

*A UDDt experience from Kuran  
village, Maharashtra, India.*

This document recites a part of the ongoing process of sanitation at a village called Kuran, 40km from the city of Pune, Maharashtra, India. The village which is located on a hillside, is distributed in hamlets at four levels. A couple of issues to be considered are:

- Open defecation is the current norm due to the lack of sanitation facilities.
- Each hamlet stands on a different strata ranging from hard rock to deep soil to a high ground water table.
- Although the village is close to the Varasgaon dam, water is pumped to a common tap for each hamlet, from where it is collected mostly by women. Electricity being intermittent, so is the water supply.

A UDDT was demonstrated as a viable alternative to conventional soak pits or septic tanks. Sendriya Shouchalaya (literally, Organic Toilet) was its new name in Marathi, the local language.

*Please note: This particular UDDT does not have a separate wash bowl for anal cleansing since the family did not wish to reuse the urine. Here the urine bowl doubles up as the wash bowl and the outflow is diverted to the bananas.*



1: The place almost asks for an UDDt, the bananas awaiting urine...

2: Excavation filled with rubble

3: Cement being applied to the rubble footing

4. Nearly done with the pad

5. Brickwork for the substructure, first course.



6: Substructure rises... dog leaves...

7: Fresh fish from the stream nearby. Dinner.

8: Substructure nearly done. The chamber access has been spanned using a cuddapah stone slab. The vent pipe openings have been accommodated.

9. The front

10: Substructure interior. The slot left in the division wall is where the urine bowl of the pan fits.



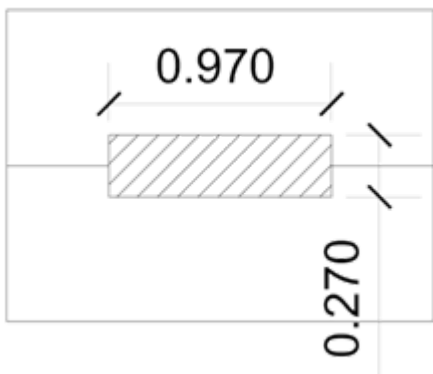

11: The Superstructure rises over two slabs of cuddapah stone joined together with a cutout in between (97cm x 27cm)

12. A million different tiles to choose from. None match..

%@^\*£# !!

13. Pan in place, tiling begins.

14. Flooring done with hard earned tiles.

15. Intricately worked out breathtaking corner detailing..



16

16: Toilet front joints receive biased treatment for aesthetic purposes. Tiling complete, interiors plastered.

17: Cement paint double coat for the exterior. Chamber covers pending.



17



18

18: Toilet front with wet cement paint. A flush door with a cuddapah stone frame shall be installed.



19: Vent pipes with mosquito nets at both ends. FRP sliding doors for chamber access. Pipe leads Urinet Wash water to bananas.

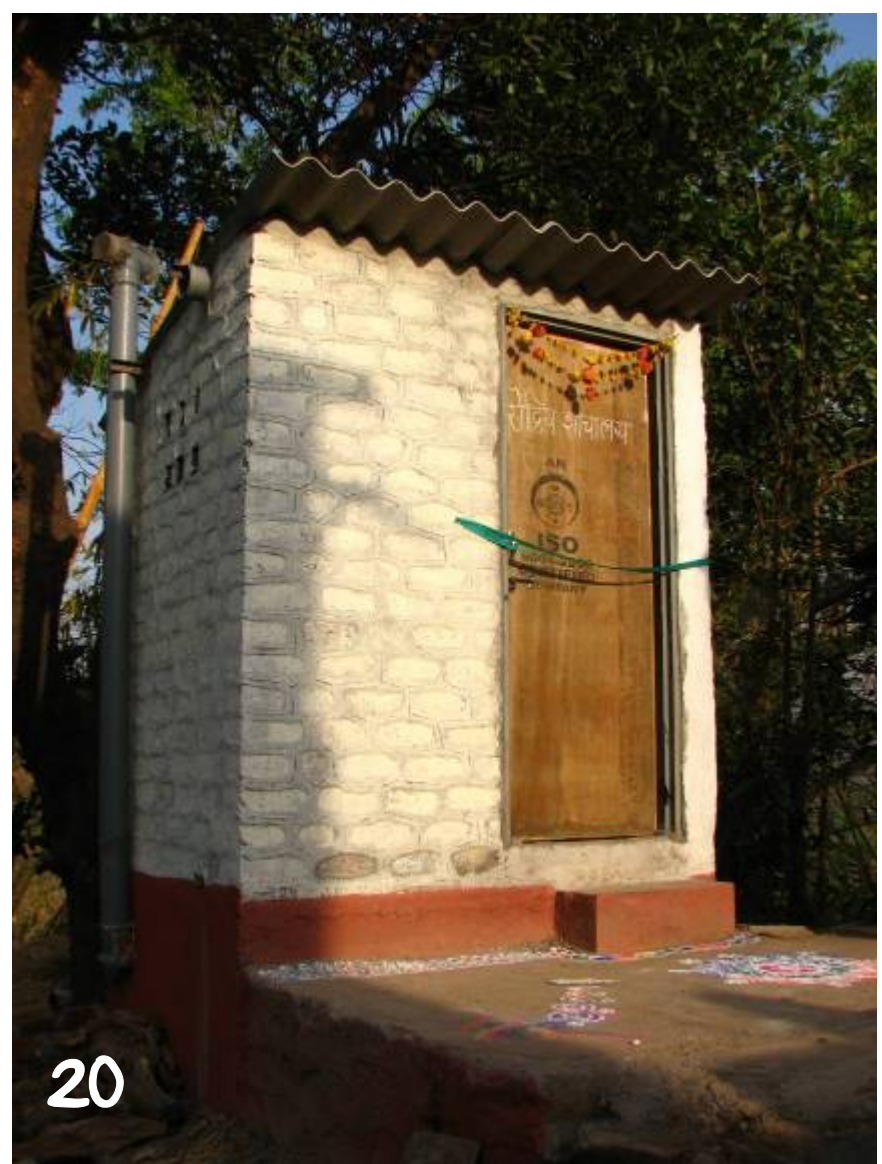

20. The Sendriya Shouchalaya..

*The owners of the Sendriya Shouchalaya:*



**Bhau**

**Kadubai**

**Anyaa**



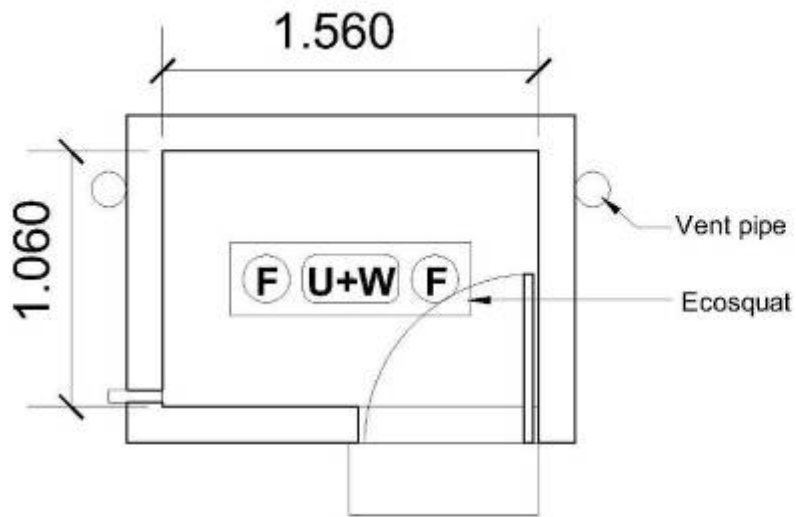

Plan: Superstructure

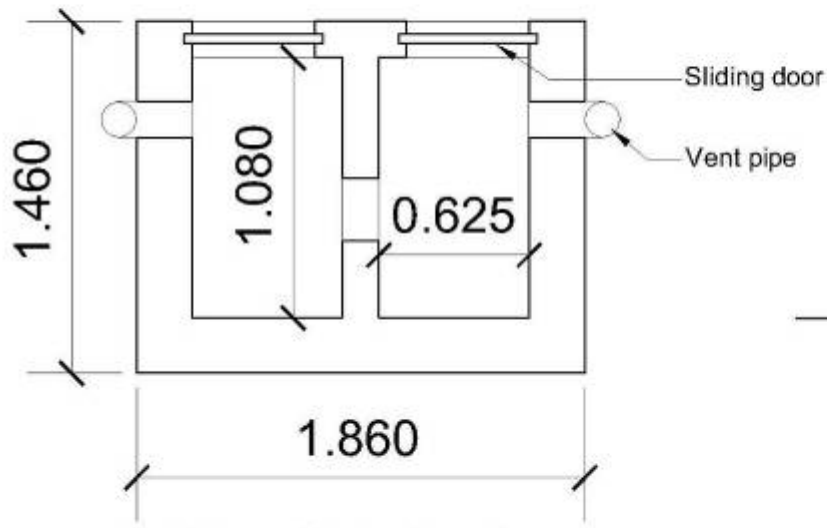

Plan: Substructure

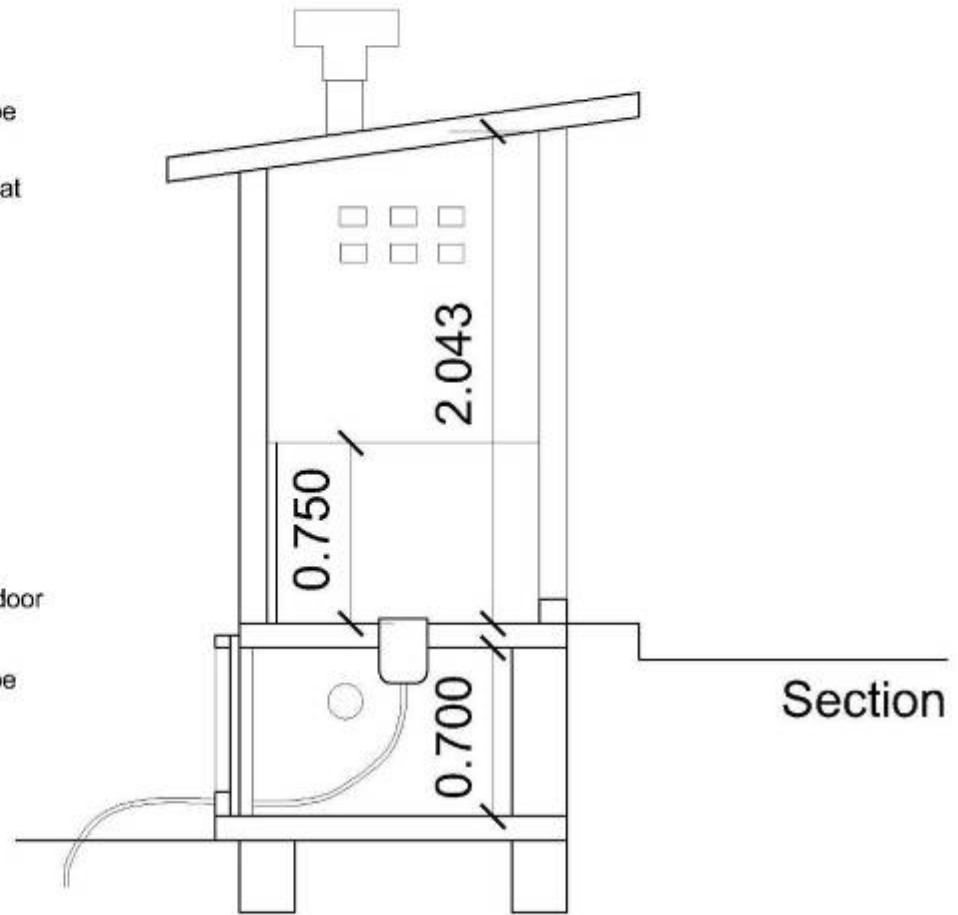

[soar.hub@gmail.com](mailto:soar.hub@gmail.com)